

SikaProof® is a registered trade mark of Sika®
SikaSwell® is a registered trade mark of Sika®
Preprufe® is a registered trade mark of GCP

All rights reserved. No part of this publication may be reproduced or transmitted in any form, or by any means, electronic or mechanical including photocopy, recording or any information storage and retrieval system, without permission in writing from SIG Trading Ltd. No information contained within this publication can be used to compile any other printed or electronic directory or mailing list. Whilst every effort has been made to ensure accuracy, the publisher does not, under any circumstances, accept responsibility for errors or omissions and no representation or warranty is made in relation to the suitability of a product for a specific application. Visuals are for illustration purposes only. E&OE.

SIGCAWB0923 V1 - © SIG Trading Ltd 2022. All rights reserved.

Waterproofing Solutions



TRUST SIG TO DELIVER

When your business needs a supplier for construction products who can offer you impartial advice and support, you need a distributor who you can trust. At SIG we are dedicated to supporting you on your projects.

As one of the UK's market-leading specialist suppliers to the construction industry, we take the time to understand the demands of our customer's project. We work with our customers throughout their project, from early design stage through to completion enabling us to provide on hand support, offering the right solution backed by our technical expertise.

You can trust the extensive product range, and excellent service of SIG to deliver what you need when you need it.

2

How SIG can support you

- ✓ We can offer you an **extensive product range** from leading manufacturers in Construction Accessories, Insulation, Fire Protection, Dry Lining, Interiors, Ceilings, Fixings & First Fix M&E and Roofing
- ✓ We provide **technical support** when you need it, including estimating and technical calculations
- ✓ With a **diverse fleet**, we have the right vehicle to deliver the product to you on site
- ✓ Our **nationwide** branch network means we're never far away
- ✓ Our **dedicated** Construction Accessories sales team are always on hand to support you



3

SIG Construction Accessories are a specialist distributor of products for Masonry, Groundworks, Geotechnical, Waterproofing, Concrete Repair and Technical fixings. Our team is made up of skilled professionals who are passionate about what they do and are dedicated to delivering the best possible solutions for our customers. We pride ourselves on our ability to tailor our services and the products available to meet the unique needs of each, and every project we work on.

With years of experience, we have developed a deep understanding of our industry, and we are always striving to stay ahead of the curve when it comes to new developments and innovations. We work with Architects and design teams in the early stages of projects, to provide value engineered solutions which consider application, sustainability and commercial viability. Once the project is on site we are on the ground supporting our customers for the duration.

When you need a supplier who has the products you need, when you need them through a national branch network, then trust SIG Construction Accessories to deliver.

Our Range of Products



1 Concrete Repair & Protection

Available products:

- ✓ Grouts & Anchors
- ✓ Primer
- ✓ Cementitious Repair Mortars
- ✓ Resin Repair Mortars
- ✓ Levelling Compounds
- ✓ Protective Coatings
- ✓ Specialist Sealants



2 Waterproofing

Available products:

- ✓ Membranes (Pre & Post-Applied)
- ✓ Bentonite
- ✓ Cavity Systems
- ✓ Liquid Applied
- ✓ Cementitious
- ✓ Waterstops
- ✓ Waterproofing Accessories

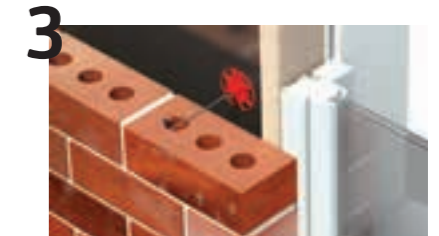

3 Masonry

Available products:

- ✓ Masonry Support Systems
- ✓ Windposts & Parapet Posts
- ✓ Lintels
- ✓ Surface Fixed Wall Channel
- ✓ Brick Reinforcement
- ✓ Wall Ties & Restraint Fixings
- ✓ Head Restraints
- ✓ Remedial Wall Ties
- ✓ Wall Starter Systems
- ✓ Builder's Metalwork
- ✓ Damp Proof Course Systems & Accessories (DPC)
- ✓ Cloak Units, Cavity Trays & Abutment Trays
- ✓ Crack Stitching Injection
- ✓ Brickwork Joint Filler
- ✓ Brickwork Protection
- ✓ Through Wall Ventilation
- ✓ Wall Ventilation/Weep Vents



4 Groundwork Engineering

Available products:

- ✓ Geotextiles
- ✓ Geogrids
- ✓ Walls/Gabion Baskets
- ✓ Erosion Control & Matting
- ✓ Cellular Confinement System
- ✓ Root & Weed Barriers
- ✓ Grass Protection Mesh
- ✓ Geocomposite Drainage
- ✓ Clay Liners & Plastic Membranes
- ✓ Gas/Hydrocarbon Barriers
- ✓ Clayheave/Void Former Insulation
- ✓ Permeable Paving
- ✓ Slope Stability

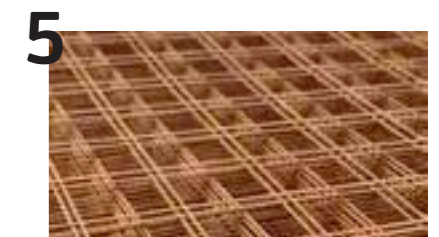

5 Reinforcement & Formwork

Available products:

- ✓ Reinforcement Mesh
- ✓ Reinforcing Bars
- ✓ Cut & Bent
- ✓ Reinforcement Spacers
- ✓ Dowel Bars & Accessories
- ✓ Tying Wire
- ✓ Concrete Slab Accessories
- ✓ Beamform/Ground Prop
- ✓ Tie Bar Systems
- ✓ Column Formers
- ✓ Expanded Metal Formwork
- ✓ Screed Rails & Accessories
- ✓ Crack Inducers & Void Formers
- ✓ Structural Concrete Reinforcement
- ✓ Cast-in Channels
- ✓ Floor Decking
- ✓ Brick & Concrete Cleaning Materials
- ✓ Continuity Systems
- ✓ Formwork Chemicals



Waterproofing Protection

Our SIG Construction Accessories Waterproofing specialists support Clients and Contractors throughout their projects from design to product selection.

We Offer

Early involvement where we work with leading manufacturers to ensure the products are suitable for application.

We Understand

The British Standard BS 8102:2022 Protection of Below Ground Structures Against Water Ingress. The standard gives guidance on methods of dealing with and preventing the entry of water from external sources into structures - categorising into 3 types of waterproofing protection Type A, B & C.

Type A Barrier Protection

Type A Barrier Protection, also commonly known as "Tanking" is the prevention of water from penetrating into a structure, by forming a barrier between the structure and any groundwater. The type of barrier protection recommended will be dependent upon the type of structure, water pressure and project requirements.

Type B Structurally Integral Protection

Structurally Integral Protection (Type B), is a method whereby waterproofing additives or systems are incorporated directly into the structural elements of the external shell - preventing the structure itself against water ingress. Working to create a barrier on the surface of the structure it can reduce or eliminate the need for external waterproofing.

Type C Drained Protection

Type C Drained Protection, also referred to as drained cavity waterproofing, is a method which creates a cavity between the exterior surface and the waterproofing layer. The gap which is created provides a path for the water to drain away so it does not reach the interior of the building.



Type A Barrier Protection

Applications

- ✓ Basement Refurbishment
- ✓ Storage, Plant Rooms / Workshops
- ✓ Below Ground Car Parks
- ✓ Areas **EXCLUDING** Electrical Equipment

Environment

- ✓ Some seepage and damp patches may be tolerable

Also known as "Tanking" Type A Barrier Protection is the prevention of water ingress through application of a waterproof material (liquid or membrane) to the internal or external walls and floor slab of a basement or underground structure.

There is a choice of options dependent upon application, requirement and build, which can be discussed with our waterproofing specialists and valued supply partners.



LIQUID APPLIED

Fosroc®

Fosroc Nitocote CM210 is a cementitious coating, used for waterproofing, water retaining and water excluding structures, suitable for Water Tanks, Reservoirs, Canals and Culverts.

EC 1272/2008
H315: Causes skin irritation
H317: May cause an allergic skin reaction
H318: Causes serious eye damage
H335: May cause respiratory irritation

Sika®-1 Waterproofer

Sika®-1 Waterproofer is an aqueous solution containing complex colloidal silicates. In the presence of water these swell and block the capillaries and pores in the applied sand cement renders, screeds and mortar to provide an effective water barrier against the transmission of liquid water. Sika®-1 Waterproofer can be used alone as an admixture or as a waterproofing system when used in conjunction with the Sika®-1 Pre-Bagged, Spritz, Render, Screed and Finishing Mortars.

EC 1272/2008
Not Classified



KEY PRODUCTS

MEMBRANES

SikaProof®

SikaProof® A-08 is an embossed polyolefin FPO sheet membrane for pre-applied fully bonded below ground waterproofing of reinforced concrete structures. Membrane thickness 0,8 mm. SikaProof® A-08 is cold applied without heat or open flames to prepared substrates or onto formwork before fixing reinforcement and concrete placement. The membrane has self-adhesive longitudinal strips for bonding overlap joints and is laminated with a unique sealant and a non-woven fleece backing layer which creates a bond with the cast concrete.

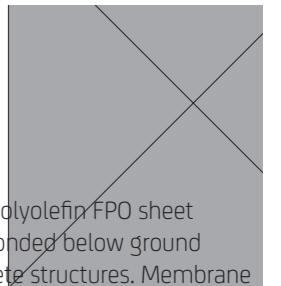

Fosroc® Proofex Engage

Fosroc® Proofex Engage is a robust pre-applied fully bonded gas-resistant waterproofing membrane for use with below ground reinforced concrete structures.

Uses: Waterproofing and ground gas resistant membrane for concrete basements lift pits, carparks and other water excluding structures. Proofex Engage can be used to achieve waterproofing to Grades 2 and 3 as defined in BS 8102: 2022



GCP Preprufe®

GCP PREPRUFE® 300R/160R Plus pre-applied waterproofing membranes are unique composite sheets comprised of a thick HDPE film, pressure sensitive adhesive, and weather resistant protective coating. Designed with Advanced Bond Technology™ and dual adhesive Ziplap™ seams, PREPRUFE® 300R/160R Plus form a unique, integral bond to poured concrete. This integral bond is specifically designed to provide a robust barrier to water, moisture and gas and prevents both the ingress and lateral migration of water.

Visqueen

Visqueen Gas Barrier is a BBA certified 13/5609 multi-layer reinforced polyethylene gas barrier with a 20 micron aluminium foil. It is flexible in design and acts as a radon and damp proof membrane. The barrier is coloured blue on the upper surface and silver on the reverse and is supplied in single wound rolls (not folded) 2m x 50m.

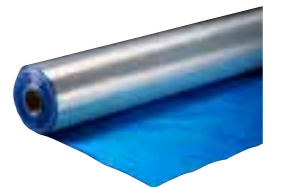

Type B Structurally Integral

Applications

- ✓ Boiler Rooms
- ✓ Retail Storage Areas
- ✓ Plant Rooms / Workshops
- ✓ Areas **WITH** Electrical Equipment

Environment

- ✓ No water penetration but some moisture vapour tolerable



Type B protection is where the structure itself acts as a barrier to prevent water ingress. Usually applied during the construction phase of the structure, the protection relies upon the design and materials which are incorporated into the external shell.

If designed correctly, it is an effective method to prevent water penetration in below-ground structures, failure is often through poor joints during design phase, so it is recommended that you engage with our specialists at an early stage of the project.



KEY PRODUCTS

Fosroc Supercast Hydrofoil



Fosroc Supercast Hydrofoil is a PVC waterstop with centre bulb sections used in expansion, contraction and construction joints. The centre bulb allows for movements in a structure to be accommodated whilst its hexagonal design provides a flat surface. This allows shuttering and joint fillers to fit snugly.

- Designed to provide an integral sealing system for movement and construction joints in concrete cast in-situ
- Available in 150, 200, and 250mm thicknesses

SikaSwell® S-2



SikaSwell® S-2 is a one part polyurethane sealant which swells in contact with water. Used to seal waterproof structures and fix SikaSwell Profiles or Sika Injectoflex.

- Easy to apply
- Good adhesion to various substrates
- Optimised expansion rate, therefore no damage to fresh concrete during curing
- Highly economical
- Swells in contact with water
- Permanently water resistant
- Adaptable to fit many different detail tasks

EC 1272/2008
H317: May cause an allergic skin reaction
H318: Causes serious eye damage

SikaSwell® A



SikaSwell® A is an acrylic sealing profile which swells in contact with water to seal all types of joints and penetrations in concrete. It has a rectangular profile and is available in several sizes.



Type C Drained Protection

Applications

- ✓ Residential
- ✓ Commercial
- ✓ Leisure Centres
- ✓ Archives

Environment

- ✓ Dry Environment

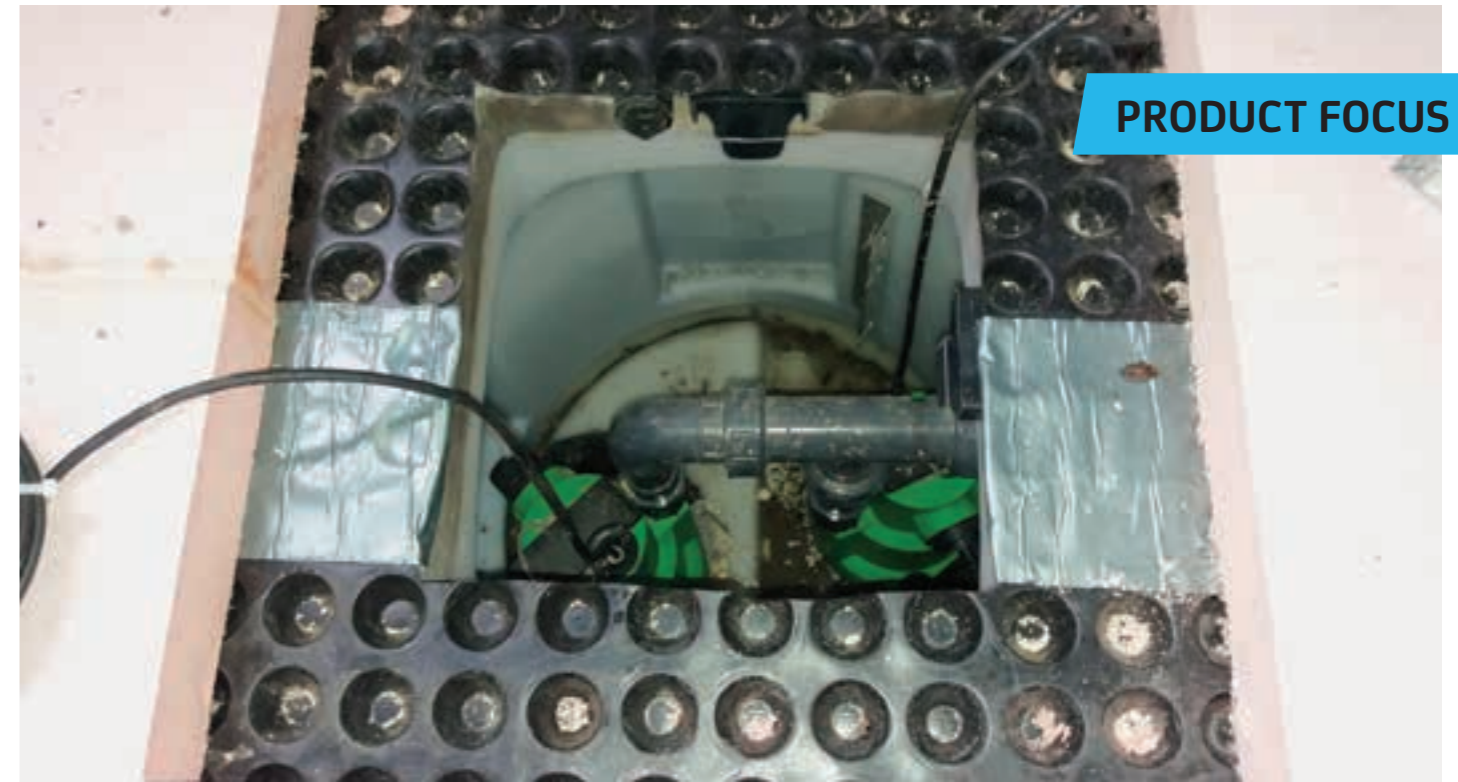

PRODUCT FOCUS

Type C protection is provided by the incorporation of an appropriate internal water management system.

Type C Protection allows moisture or running water to penetrate through the external wall or floor of the structure and to travel behind the membrane in a controlled drainage system.

Type C systems collect and manage any water ingress by diverting it into a designated safe point of disposal (such as a sump pump/package pump station).

Cavity Drain Membranes are studded on the external facing surface, allowing any water that penetrates the structure to flow into designed drainage channels. The drainage channels carry any water ingress to either a sump and pump chamber or away from the structure if passive drainage is possible.



SUSTAINABILITY

SIG are committed to building modern, sustainable, and safe living and working environments in the communities in which we operate, while also doing what we can to influence the industry to take meaningful environmental action.

As we respond to climate change and rising energy costs, addressing our own carbon footprint is crucial. We also want to play an influential leadership role in the transition to sustainable construction through our central position in the building materials supply chain.

We say that SIG was born green because since we were founded, we have supported the drive for better energy efficiency standards and greater protection for the environment. Our five group-wide sustainability commitments, launched in 2022, support our renewed focus.



NET ZERO CARBON BY 2035

We have committed to net zero carbon in SIG's operations by 2035 at the latest and as stated in 2021, we aim to achieve this target by meeting the following secondary goals:

- 80% reduction against total Scope 1, 2 and business travel emissions by 2035 (using 2021 emissions as a base year) and offsetting any residual emissions
- Cars and forklifts ("FLT"s) to be 100% electric by 2030
- Commercial vehicles to be 100% electric, hydrogen, or lower-carbon alternative by 2035 (although this continues to be dependent on the pace of progress in the development of external technology, especially for HGVs).



PARTNER WITH MANUFACTURERS AND CUSTOMERS TO REDUCE CARBON AND WASTE ACROSS THE SUPPLY CHAIN

Our commitment is to partner with manufacturers and customers to reduce carbon and waste across the supply chain.

As a specialist distributor of products central to building energy efficiency, SIG is at the heart of the supply chain, uniquely placed to help suppliers and customers meet their own sustainable construction ambitions.

SIG's role is to provide choice, data transparency and expertise on regulatory compliance. We are working to identify and promote more sustainable products from new and existing suppliers.



ZERO SIG WASTE TO LANDFILL BY 2025

Our commitment is for zero SIG waste to landfill by 2025. Our primary responsibility is the SIG waste that we directly control, including monitoring and validating third-party waste contracts for our sites. This will be achieved by waste segregation, reuse of packaging and paperless processes.

However, the nature of our role as a distributor in the middle of the supply chain, handling logistics between customers and suppliers, means we are already coordinating complex logistics and breaking bulk, which helps reduce on-site waste (both materials and labour) in construction. We are also well placed to support a circular economy by recycling and repurposing materials to reduce waste and raw materials extraction.



HEALTH AND SAFETY

We are committed to being a health and safety leader in building materials distribution and to providing workplaces that assure the safety, health and wellbeing of our employees, contractors, and stakeholders.



OUR PEOPLE

Our commitment to our people is to make sure they feel safe, proud, and valued. Their health and wellbeing are integral to this. Now more than ever, we will do what we can to support, educate and provide opportunities for our people to stay happy and healthy at work.

Contact SIG construction accessories today for...

- Structural Waterproofing
- Groundwork Engineering
- Geotechnical
- Concrete Repair & Protection
- Masonry
- Reinforcement & Formwork

Scotland

Aberdeen

Woodside Road, Bridge of Don,
Scotland, AB23 8EF
01224 825 825

Cambuslang

95 Westburn Drive, Glasgow,
Scotland, G72 7NA
0141 445 7960

North

Leeds

Intermezzo Drive, Pontefract Road,
West Yorkshire, LS10 1RU
0113 272 4025

Sheffield

Nunnery Drive, Sheffield, South
Yorkshire, S2 1TA
0114 241 3000

Manchester

Unit 1, Trafford Point 1, Trafford
Park, Manchester, M17 1SH
0161 836 4488

Tyneside

Federation Business Park, St
Omers Road, Gateshead, NE11 9EE
0191 487 4983

Midlands

Aston

91 Chester St, Birmingham, B6
4AE
0121 522 0200

Norwich

White Lodge Business Park, Hall
Road, NR4 6DQ
01603 765 660

West

Bristol

Unit 13 Concorde Road, Patchway,
Bristol, BS34 5TB
0117 301 3620

Plymouth

87 St Modwen Road, Parkway
Industrial Estate, Plymouth, PL6 8LH
01752 675 400

West London

Ash Vale

Lysons Link South, Lysons Avenue,
Surrey, GU12 5GN
01252 527 000

Bedford

Telford Way, Bedford, Bedfordshire,
MK42 0PQ
01234 268 427



Speak to your local SIG
Construction Accessories Branch